

TOWERING TRANQUILITY

DEVELOPER : Mirvac

MAIN CONSTRUCTION COMPANY : Mirvac Construction

ARCHITECT : Mirvac Design

STRUCTURAL ENGINEER : Mordue

CONSTRUCTION VALUE : \$160 million

Voyager is a luxury residential tower comprising 310 apartments, which features exquisite one, two and three bedroom apartments and flexi townhomes, and a rooftop space featuring a dining room with chef's kitchen, bar, cinema/karaoke room, and an open air lounge with fire pit, set against the incredible Melbourne city skyline.

Mirvac is one of Australia's most innovative property groups and has been making a positive contribution to cities and urban landscapes for close to 50 years. Mirvac's latest contribution is the prestigious Voyager at Yarra's Edge – a shimmering beacon with luxury apartments in one of Melbourne's most idyllic locations.

The tallest of all the buildings to date at the waterfront location, is another prime example of Mirvac's commitment to delivering high end residential projects across Victoria and joins The Eastbourne in East Melbourne, Tullamore in Doncaster and Harcrest in Wantirna South in the company's enviable portfolio.

“At the heart of every Mirvac project is a customer first approach, combined with research based market knowledge, ensuring that our projects are aligned with current trends and demands,” said Elysa Anderson, Mirvac's General Manager, Residential Victoria. “We have a unique integrated approach with design, development and marketing sitting under one roof, so the project vision is shaped directly by the wants and needs of our customers and wider market.”

The award-winning, inhouse design team which has brought the architecture and interiors to life is Mirvac Design and with its hotel-luxe interiors and a rooftop resident mecca – a first for the precinct – Voyager has exceeded the industry's expectations and more.

Voyager has been designed to be a landmark entrance to Melbourne's CBD from the Bolte Bridge and, at approximately 130m tall, it dominates the skyline from every angle, courtesy of its shimmering bronze curved façade and architecturally distinct design. The curved surfaces continue through to the lobby which features a cosy resident lounge with fireplace and an inspiring art gallery.

The prestigious tower is home to 310 apartments including artist and home office apartments, plus one, two and three bedroom luxury residences and the health

and fitness facilities at the Wharf Club are second-to-none.

“Voyager is our response to the demand for quality housing and amenities in well connected, inner-city locations and Yarra's Edge, which is a rare, 14.5 hectare sanctuary located on the north facing bank of the Yarra River, is now home to more than 3,000 residents,” Anderson said.

Taking the amenities to dramatic heights, the exclusive rooftop space on Level 43 is an impressive drawcard and again, a first for Yarra's Edge. Encased in glass, the double height retreat is adorned with climbing greenery and features indoor and outdoor facilities for private dining as well as a bar, lounge area, theatre and karaoke room.

The internal fitouts of the apartments are a display of sophistication and elegance, where residents have a choice between two beautiful colour schemes, Halcyon or Intrepid and the living areas offer both sweeping city views and an abundance of natural light via floor-to-ceiling windows.

Beautifully designed kitchens and bathrooms allow for generous storage space and the kitchens include premium appliances from SMEG or Miele, slimline stone benchtops, woodgrain veneer cabinetry and select apartments also feature wintergardens for the ultimate in contemporary living.

The two and a half year construction of Voyager saw Mirvac induct approximately 1,500 people on site in total, with an average of

250-300 per day through peak of construction period resulting in Mirvac successfully delivering the project on time.

“Mirvac's unique end-to-end inhouse capability provides quality control, flexibility of timing and delivery and the ability to take a longer term view,” Anderson explained. “The completion of Voyager in the face of COVID-19 was an example of Mirvac's flexibility and commitment to our integrated model, with our project vision being shaped by the wants and needs of the market at any given time.”

Captivating in its design and first class facilities, the completion of Voyager demonstrates Mirvac's continued confidence in the Victorian property sector.

“Voyager is a significant milestone for Yarra's Edge, as well as the broader Fishermans Bend and Docklands communities,” Anderson said. “It celebrates the ongoing delivery of the future vision for Yarra's Edge, which has seen the regeneration and transformation of these former wharves into a thriving waterfront precinct.”

Voyager joins Mirvac's \$1.4 billion Victorian apartments portfolio which will soon include two new projects which are currently underway – Park Street, Brunswick and T9 at Yarra's Edge, Melbourne Docklands.

For more information contact Mirvac Residential Victoria, Level 5, 6 Riverside Quay, Southbank VIC 3006, website www.mirvac.com

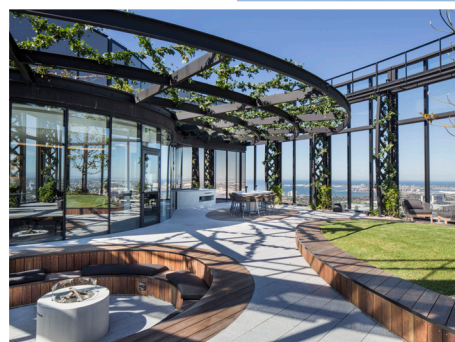

Below SYNC Industries manufactured and installed 525 bathroom pods with ample storage and stylish accents across the project.



Below IJF Australia manufactured and installed the joinery for the lobby lounge, Level 43 common areas, and the premium apartments.



SYNC Industries has been setting the benchmark for high-quality, prefabricated bathrooms since 2013 and the company's latest installment at Voyager can best be described as elevated luxury across 43-levels of contemporary one, two and three bedroom residences with unrivalled views.

Manufactured in Melbourne at the company's purpose-built facility, SYNC's bathroom pods can be specified for any development and by integrating innovative pre-fabrication and digital design technology, SYNC is helping improve the efficiency and quality of projects and promoting local jobs at the same time.

"We understand prefabricated construction very well, so our clients can leave us to work on our part of their project, knowing the components will arrive just in time and slot into place. We have developed a brilliant design, production, installation and project management team to offer a more streamlined and sustainable construction solution," said Eddie Pallotta, Operations Director of Sync Industries.

At Voyager, SYNC was engaged by Mirvac to manufacture and install 525 bathroom pods with ample storage, stylish accents and a real luxurious feel overall. The bathrooms feature both a light and dark

colour scheme with ten different typologies including baths, double vanities and shower only pods. More than just a functional space, Volare travertine tiles are perfectly complemented by the Caroma Liano Nexus range of bathroom ware and all of the finer details have been considered including plenty of storage space and modern details.

A team of 80 employees from SYNC was involved on the Voyager project ranging from designers, project managers, waterproofers, tilers and plumbers. Installation started in October 2019 and included SYNC's largest bathroom pod to date. "To achieve this, we had to make new optimisations to the structural design of the pod, ensuring it could be safely lifted into position," Eddie said. "This is what we specialise in and the fact the pods are made in a controlled factory environment with specialised machinery increases QA practices and ensures a better result."

For more information contact SYNC Industries, 55 Leakes Road, Laverton North VIC 3026, phone 03 8329 4111, email info@sync.industries, website www.sync.industries

IJF Australia has been servicing the construction industry in Australia since 1964, consistently striving to be a distinctive and relevant market leader in interior joinery. The South Australian-based company has adapted and evolved over the years to meet the changing requirements of the market as well as its clients.

The company's emphasis on developing strong partner relationships is just as important as the products and services they are sourcing and creating across projects of all scales. Their intention is to enrich the success of those they collaborate with through the manufacturing and management of superior products and services. Sustainability is an important consideration in decision-making processes, with IJF Australia always striving for new ways to reduce their environmental impact by adopting sustainable practices throughout the organisation.

At Voyager, IJF Australia was tasked with the project management, supply and installation of all joinery to the 310 residential apartments and common areas. Fit out of the joinery commenced in September 2020, and included the level 1 lobby lounge, the common area kitchen, the karaoke and theatre lounge on level 43, as well as the kitchen joinery to the premium apartments.

Designed by Mirvac Design, the curved unit which features in the lobby lounge perfectly complements the organic lines of the façade of the building, while the kitchen joinery in the premium apartments, also designed by Mirvac Design, are the epitome of luxury living where space is in abundance. The kitchens feature a timber look laminate with coloured and timber grain internal carcasses and upgraded hardware including silver cutlery trays, integrated bins and some with a butler's pantry.

The IJF Australia team are proud of the craftsmanship delivered through the quality and finishes at Voyager.

IJF Australia has worked with Mirvac on a number of projects, including a new project at the Queen Victoria Markets Munro development, which consists of a hotel and residential apartments. The team at IJF Australia are looking forward to continuing the great working relationship with Mirvac.

For more information contact IJF Australia, 41-43 Cormack Road, Wingfield SA 5013, phone 08 8349 7400, email hr@ijf.com.au, website www.ijf.com.au



Below Signcraft manufactured a range of signage throughout the project including feature signs, wayfinding and apartment numbers.

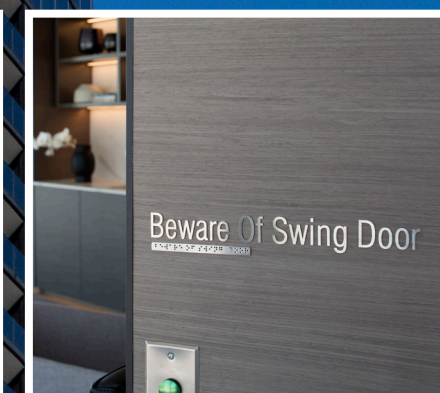
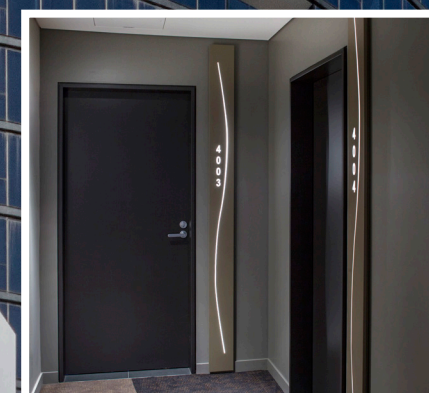

Signcraft has been creating lasting impressions on new developments and re-brands all around Australia for the last five decades, with tailored solutions including architectural signage, fabricated letters and fascia signage to name a few.

At Voyager, the 43-storey residential tower at Yarra's Edge, Signcraft's expert team of project managers, designers and engineers set about to make a statement that would complement the luxury development. The 4.2m long, 320-degree curved fabricated steel sign at the main entrance certainly catches the eye and Signcraft has also manufactured the braille and statutory signage, wayfinding, vinyl, safety strip and carpark signage, as well as the illuminated apartment numbers.

"The external 'Voyager' laser cut steel sign gives the illusion that it's floating on the tiles and curves along the façade of the building and is reflected through the floor-to-ceiling glazing," said Kristie-Lee King Project Manager at Signcraft.

"Our Senior Mechanical Designer worked diligently with the architect and designer to ensure that what we created had met the client's expectations in relation to the external signage and in terms of the project as a whole, we are really pleased with the outcome at Voyager."

Engaged by Mirvac for what has been one of numerous projects together, Signcraft's work at Voyager combined the company's electrical department, graphics team, metal fabricators, dispatch and logistics experts, all committed to delivering a high-quality outcome for the project.

"We have developed a strong working relationship with Mirvac and the project team and this type of collaboration enables us to truly understand their project needs and signage expectations so that we can deliver the best possible results," Kristie-Lee said.

What is considered slightly out of the ordinary, the statutory, braille and tactile signage that is presented at Voyager has been designed and manufactured to specific requirements and the initial survey process was essential in getting the construction drawings right.

Signcraft recently celebrated their fifty-year anniversary of providing high-quality signage solutions to the construction industry.

For more information contact Signcraft, 580-598 Kororoit Creek Road, Altona North VIC 3025, phone 03 9360 6222, email customerservice@signcraft.com.au, website www.signcraft.com.au



Voyager, Victoria